

Lossnay Component for residential, commercial or light-industrial use.  
**Remote Controller**

Model

# PZ-41SLB-E

## Operating Manual (For the user)

This remote controller is to be connected to a Lossnay unit to allow that unit to be started and stopped, and to allow selection of the ventilation mode and of the fan speed.

In order to ensure that the remote controller and Lossnay unit can be operated both correctly and safely, it is important that this user's manual be read fully and carefully.

**This remote controller may be installed without the assistance of specialist contractors (however; safety and functionality will not be guaranteed in such a case).**

### Essential Safety Precautions

● The following symbols are used in this manual to indicate possible dangers and the corresponding levels of seriousness associated with failure to observe the correct operating procedures.

#### WARNING

When this symbol is displayed, it indicates that failure to follow the given instructions may result in serious injury or even death.

- This Lossnay remote controller must not be modified in any way; unnecessary disassembly is also prohibited. (Failure to follow this precaution could result in the outbreak of fire, in abnormal operation, or in associated injuries.)
- This Lossnay remote controller must not be splashed with water or have water applied in any other way. (Failure to follow this precaution could result in the outbreak of fire or in electrical shock.)

#### NOTICE

- The use of this Lossnay remote controller in special environments should be avoided. In particular, the remote controller should not be used in locations where there are considerable amounts of oil, grease, vapor, or toxic gasses present. (Failure to follow this precaution could result in impaired functionality or in damage to remote-controller components.)
- Please refrain from the use of sharpened or pointed object to operate any of this remote controller's buttons. (Failure to follow this precaution could result in component damage or breakdown.)
- Do not allow this Lossnay remote controller to come into contact with harmful sprays such as insecticides, pesticides, and cleaning agents. (Failure to follow this precaution could result in the deterioration of components or in component damage.)

### Component Names

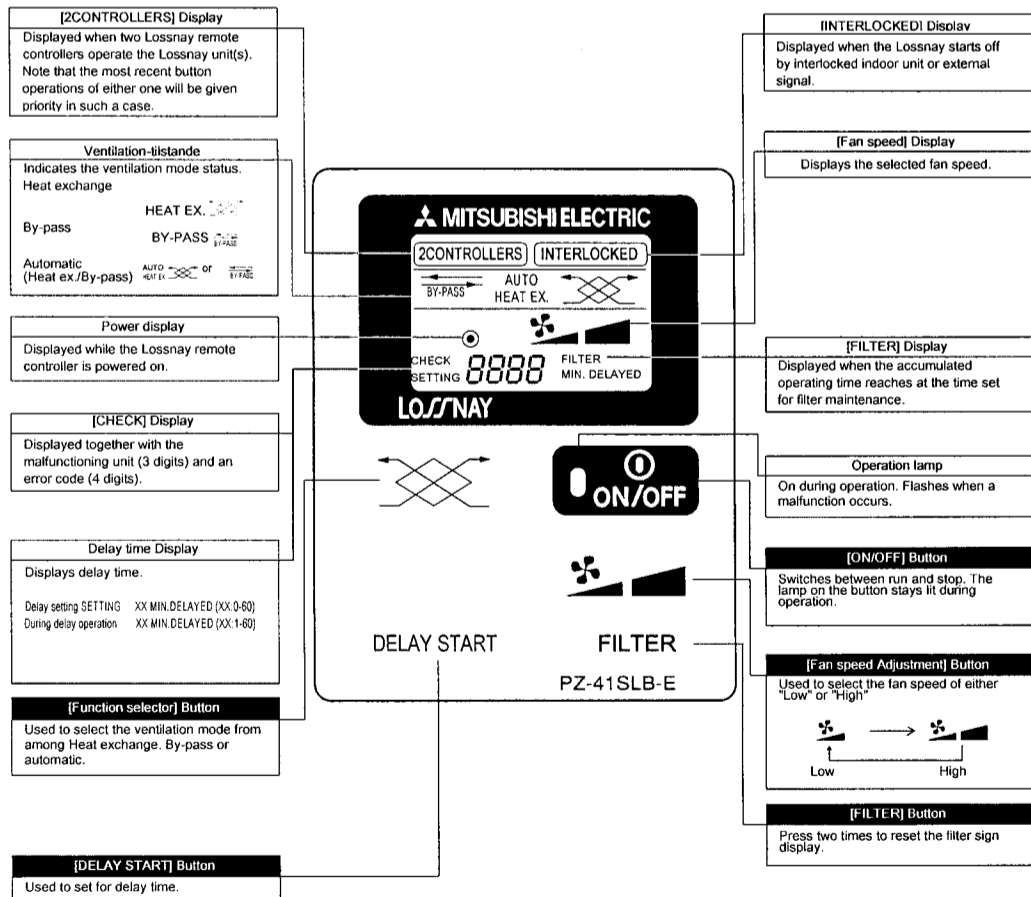

※Entire panel is displayed for explanation.

**Note:**

- When power is restored after an outage or when the corresponding breaker for the distribution box is reset, all modes will return to the condition before the supply of power was interrupted.

## Mode of Use

### < Independent Operation of the Lossnay Unit >

Operation	Relevant button	Relevant display items	Sequence
1. Starting the Lossnay unit	Operation lamp		Press the ON/OFF button and confirm that the Operation lamp turns on. The 2CONTROLLERS display item will be turned on if a double set of remote controllers is currently in use.
2. Setting the Ventilation mode			Press the Function selector button: Each time it is pressed, the corresponding display will change in accordance with the sequence [HEAT EX.] (non-automatic) → [BY-PASS] (non-automatic) → [AUTO]. If [AUTO] is selected, the display will change to indicate the current situation after two seconds have passed.
3. Selecting the fan speed			Press the Fan Speed selector button to select either Low or High fan speed.
4. Stopping the Lossnay unit	Operation lamp		Press the ON/OFF button. (Press the ON/OFF button to turn off the Operation lamp.)

### < Interlocked Operation with Indoor unit or external signal >

The Lossnay unit can be set up in such a way that it may be turned on and off by external device such as an air conditioner. In such a case, the remote controller's INTERLOCKED display will be turned on. Note that the selection of ventilation mode and of fan speed can be performed in the same way as for independent operation of the Lossnay unit.

#### Settings for Interlocking the Lossnay unit with external device

Setting	Relevant button	Relevant display items	Sequence
<b>Delay time</b> This setting is used to determine how long will elapse after the start of operation of the external device until the Lossnay unit begins to operate.	Delay Start button		Each time the Delay Start button is pressed, the delay time will change in accordance with the repeating sequence 0 → 10 → 20 → 30 → 40 → 50 → 60 (minutes) ↑ When the button is released before 5 seconds have elapsed, the display will turn off and the current delay time will be selected. Note that a delay time of 0 minutes is set before shipment from the manufacturing plant.
<b>Interlocked mode</b> This setting is used to determine the way in which the Lossnay will respond to starting and stopping of interlocked to an external device such as an air conditioner, etc. * Note that the delay time will be invalidated in situations where a setting of [3] has been selected for the Operation mode or when the Lossnay unit is interlocked with a building-management system.			1. Press and hold the Function selector button for at least 5 seconds to display the interlock setting. Note that this is set to [1] before shipment from the manufacturing plant.  2. Press the Function selector button to change the setting in the repeating sequence 2 → 3 → 4 → 1 When the button is released before 5 seconds have elapsed, the display will turn off and the current setting will be selected.

### Mode of Use(cont.)

#### ■ Interlocked Operation mode types and actions

Display number	Interlocked Operation mode	Action (of the air conditioner)	Action (of the building-management system)
1	On/Off Interlocking: Subsequent operation with the remote controller possible	When the external air conditioner begins to operate, the Lossnay unit will also begin to operate; when the external air conditioner stops operating, the Lossnay unit will also stop operating.	The Lossnay unit toggles between On and Off conditions in response to signals (or pulses) which are input from a building-management system or the like.
2	On interlocking	When the external air conditioner begins to operate, the Lossnay unit will also begin to operate; stopping of the Lossnay unit must be performed using the remote controller.	The Lossnay unit begins to operate in response to a signal (or pulse) which is input from a building-management system or the like; stopping of the Lossnay unit must be performed using the remote controller.
3	Off interlocking	When the external air conditioner stops operating, the Lossnay unit will also stop operating; starting of the Lossnay unit must be performed using the remote controller.	The Lossnay unit stops operating in response to a signal (or pulse) which is input from a building-management system or the like; starting of the Lossnay unit must be performed using the remote controller.
4	On/Off Interlocking: External inputs have priority	Same as for setting 1 above; however, it is not possible to stop the Lossnay unit using the remote controller while the external air conditioner is operating.	Same as for setting 1 above.

### Care and Upkeep

#### Actions required when the Filter Cleaning display begins to flash:

	Relevant button	Relevant display items	Sequence
Filter reset (i.e., clearing the total Lossnay-unit operating time)	(Press twice)		Press the Filter button twice in immediate succession and confirm that the Filter display turns off.
Cleaning of the Lossnay unit's filter	Perform cleaning of the air filter and the Lossnay element in accordance with the instructions in the user's manual which was provided with the Lossnay unit.		
Care of the remote controller	To remove dirt from the remote controller's display window, wipe with a cloth to which detergent has been applied, and then wipe with a dry cloth to remove any remaining detergent. Do not use the following solvents. (They will change the quality and the color.) ● Paint thinner, alcohol, benzene, gasoline, kerosene, spray cleaner, cleaning alkali, etc.		

### After-Sales Service

■ If any of the following inspection numbers should be displayed on the remote controller, please contact the retail outlet from where this product was purchased for more information.

4000, 5101, 5102, 3602, 0900

■ After-sales servicing of the remote controller unit should be ordered from the retail outlet from where this product was purchased.