

2-3. Simple ME remote controller [PAC-SE51CRA]

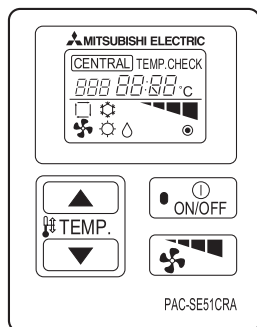

■ Functions

□:Each unit ○:Each group ●:Each block
△:Each floor ◎:Collective ×:Not available

Item	Description	Operations	Display
ON/OFF	ON and OFF operation for a single group	○	○
Operation mode switching	Switches between Cool / Dry / Auto / Fan / Heat. Operation modes vary depending on the air conditioner unit. Auto mode is the City Multi R2 and WR2 series only.	×	○
Temperature setting	Sets the temperature for a single group Range of temperature setting Cool/Dry : 19°C - 30°C (14°C - 30°C) Heat : 17°C - 28°C (17°C - 28°C) Auto : 19°C - 28°C (17°C - 28°C)	○	○
Fan speed setting	Models with 4 air flow speed settings: Hi/Mid-2/Mid-1/Low Models with 3 air flow speed setting: Hi/Mid/Low Models with 2 air flow speed settings: Hi/Low Fan speed setting varies depending on the model.	○	○
Air flow direction setting	Air flow direction angles (4-angle, Swing) Louver ON/OFF Air flow direction settings vary depending on the model.	×	×
Timer operation	Not available	×	×
Permit / Prohibit local operation	Individually prohibit operation of each local remote control function (ON/OFF, Set temperature). ※1: When the local remote controller inactivation command is received from the master system controller, "CENTRAL" is displayed.	×	※1 ○
Indoor unit intake temperature	Measures the intake temperature of the indoor unit only when the indoor unit is operating.	×	×
Error	When an error is currently occurring on an air conditioner unit, the afflicted unit and the error code are displayed.	×	□
Test run	This operates air conditioner units in test run mode. ※2: The display for test run mode will be the same as for normal start/stop (no display "test run").	×	※2 ○
Ventilation equipment	Up to 16 indoor units can be connected to an interlocked system that has one LOSSNAY.	○	×
Function to limit the setting range of room temperature (Set temperature range limit)	The range of room temperature setting can be limited by the initial setting. The lowest limit temperature can be made higher than the usual (19°C) at cooling/drying, while the upper limit temperature lower than the usual (28°C) at heating. ※ This function is available only when applying together with TG-2000A	×	○

- Control: ON/OFF, room temperature, fan speed.
- The only wiring required is cross-overwiring based on two-wire signal lines.
- Room temperature sensors are built-in.
- Ability to limit the set temperature by AG-150A/GB-50A (upper and lower temperature can be set)
- Can operate all types of indoor units

※: Since this controller has limited functions, it should always be used in conjunction with standard controller or centralized controller

■ System example

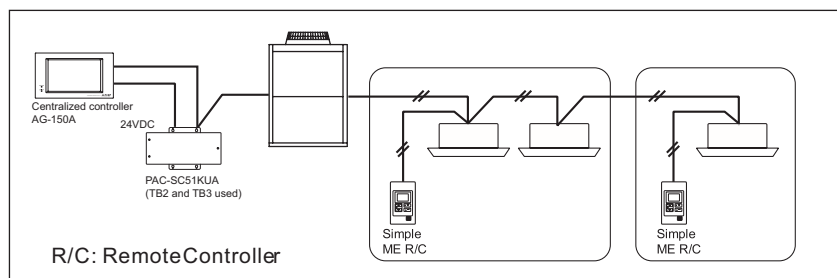

■ External dimension

