



# MSH-GA50VB

Heat Pump

R410A Classic Wall Mounted System

Mitsubishi Electric's new range of high specification, flat panel wall mounted models make use of traditional fixed speed technology, whilst providing extremely good value for money, costing approximately 30% less than the inverter equivalent. These units have extremely quiet sound levels, whilst also delivering economical air conditioning, with improved COP/EER figures. Ideal for use in any size room, this unit comes equipped with a wide-angle airflow system, as well as an automatic swing vane, allowing airflow to be extended to every corner of a room.

- **Air Cleaning Filter is optional**



Pictures not to scale

## Product Details

MSH-GA50VB Indoor Unit	
Capacity (kW):	
Heating (Nominal)	5.2
Cooling (Nominal)	5.0
Heating (UK)	4.3
Cooling (UK)	4.95
SHF R410A (Nominal)	0.65
COP / EER (Nominal)	3.23 / 2.81
Energy Label Heating / Cooling	C / C
Width - mm	325
Depth - mm	258
Height - mm	1100
Weight - kg	16
Airflow (m3/min) (Heating /Cooling) - Lo-Mi-Hi	8.8-10.7-12.8 / 8.8-10.7-12.8
Noise (dBA) (Heating/Cooling) - Lo-Mi-Hi	34-38-42 / 34-38-42
Pipe Size Gas mm (in)	12.7 (1/2)
Pipe Size Liquid mm (in)	6.35 (1/4)
Electrical Supply	Fed by outdoor unit
Phase	Single
Fuse Rating (BS88) - HRC (A)	6
Power Input (kW) - Heating (Nominal)	0.06
Power Input (kW) - Cooling (Nominal)	0.06
Power Input (kW) - Heating (UK)	0.06
Power Input (kW) - Cooling (UK)	0.06
Running Current (A) - Heating / Cooling	0.3 / 0.3
Interconnecting Cable No. Cores	2

MUH-GA50VB Outdoor Unit	
Width - mm	850
Depth - mm	290
Height - mm	605
Weight - kg	47
Noise (dBA) (Heating /Cooling) - Lo-Mi-Hi	34-38-42 / 34-38-42
Electrical Supply	220-240v, 50Hz
Phase	Single
Fuse Rating (BS88) - HRC (A)	16
Power Input (kW) - Heating (Nominal)	1.55
Power Input (kW) - Cooling (Nominal)	1.72
Power Input (kW) - Heating (UK)	1.405
Power Input (kW) - Cooling (UK)	1.364
Starting Current (A)	37
Running Current (A) - Heating / Cooling	7.23 / 7.93
Mains Cable No. Cores	3
Max Pipe Length (m)	25
Max Height Difference (m)	10
Charge (kg) - 7m	1.8

## Dimensions

### MSH-GA50VB

Upper View >

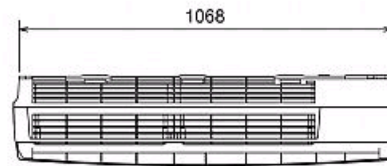

Front View >

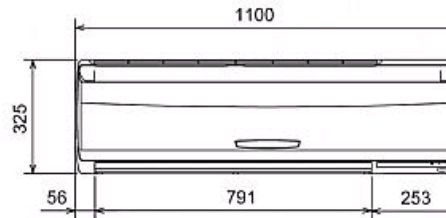

Side View >

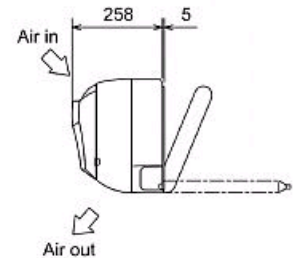

### MUH-GA50VB

Upper View >

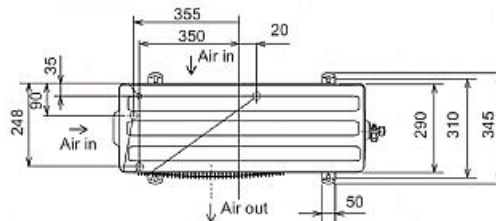

Front View >

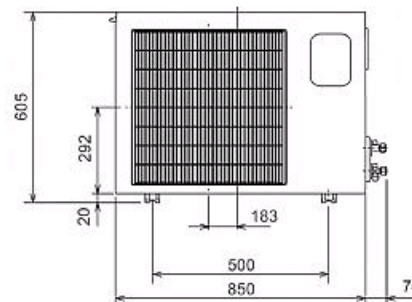

Side View >

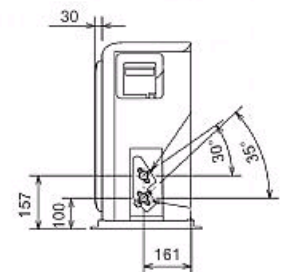

Telephone: 01707 282880

Email: [air.conditioning@meuk.mee.com](mailto:air.conditioning@meuk.mee.com) Website: <http://www.mitsubishielectric.co.uk/aircon>

Mitsubishi Electric reserves the right to make any variation in technical specification to the equipment described, or to withdraw or replace products without prior notification or public announcement.

Tel:  
Fax:

