

Air Conditioning

Product Information

PKA-RP71KAL : Power Inverter Heat Pump

R410A Wall Mounted System

Mr.SLIM™



Our wide range of power inverters offer customers high seasonal efficiency, advanced control options and quiet operation, whilst providing greater flexibility and ease of installation.



FEATURES



INDOOR

| | |
|---|---------------------|
| Heating capacity (kW) (nominal) | 8.0 (3.5 - 10.2) |
| Cooling Capacity (kW) (nominal) | 7.1 (3.3 - 8.1) |
| Heating Capacity (kW) (UK) | 6.8 (3 - 8.65) |
| Cooling Capacity (kW) (UK) | 6.55 (3.05 - 7.45) |
| SHF (nominal and UK) | 0.78 |
| COP/EER (nominal) | 3.65 / 3.94 |
| SCOP / SEER | 4.3 / 6.5 |
| Energy Efficiency Class - Heating / Cooling | A+ / A++ |
| Airflow (m³/min) Lo-Mi-Hi | 18 - 20 - 22 |
| Pipe Size Gas (mm [in]) | 15.88 (5/8") |
| Pipe Size Liquid (mm [in]) | 9.52 (3/8") |
| Sound Pressure Level (dBA) Lo-Mi-Hi | 39 - 42 - 45 |
| Sound Power Level (dBA) Cooling | 64 |
| Dimensions (mm) Width x Depth x Height | 1170 x 295 x 365 |
| Weight (kg) | 21 |
| Electrical Supply | FED BY OUTDOOR UNIT |
| Phase | SINGLE |
| Fuse Rating (BS88) - HRC (A) | 6 |
| Interconnecting Cable No. Cores | 4 |

OUTDOOR

| | |
|---|----------------------|
| Sound Pressure Level (dBA) Heating / Cooling | 48 / 47 |
| Sound Power Level (dBA) Cooling | 67 |
| Weight (kg) | 67 |
| Dimensions (mm) Width x Depth x Height | 950 x (330+30) x 943 |
| Electrical Supply | 220-240V, 50HZ |
| Phase | SINGLE |
| System Power Input (kW) - Heating / Cooling (nominal) | 2.19 / 1.80 |
| System Power Input (kW) - Heating / Cooling (UK) | 1.86 / 1.60 |
| Starting Current (A) | 6 |
| System Running Current (A) [MAX] - Heating / Cooling | 8.75 / 7.79 [19.4] |
| Fuse Rating (BS88) - HRC (A) | 25 |
| Mains Cable No. Cores | 3 |
| Max Pipe Length (m) | 50 |
| Max Height Difference (m) | 30 |
| Charge R410A (kg) - pre charged length (m) | 3.5 - 30 |

DIMENSIONS

PKA-RP71KAL

Front View >

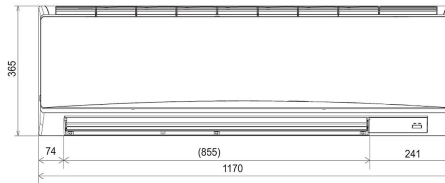

Side View >

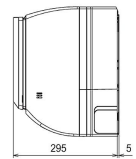

DIMENSIONS

PUHZ-ZRP71VHA

Upper View >

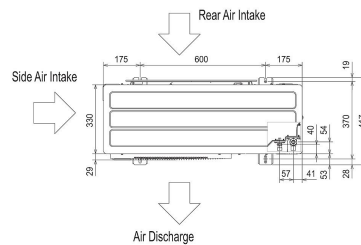

Front View >

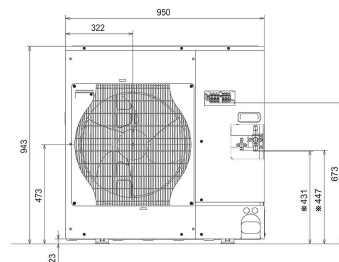

Right Side View >

